

FEATURES

Small size, high capacity

Simple construction and high reliability

PCB Mounting or Socket Type

Indicator light is available.

  Pending

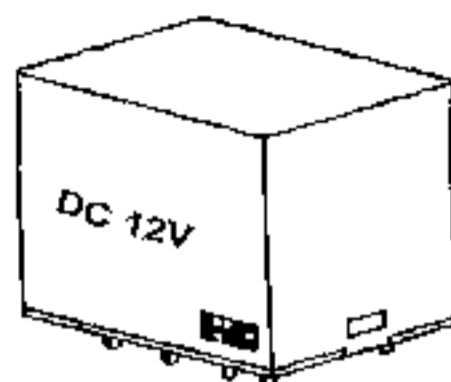

SPECIFICATIONS

COIL RATING

| | RATED VOLTAGE (V) | COIL RESISTANCE Ω +/- 10 % | MUST OPERATE VOLTAGE | MUST DROPOUT VOLTAGE | MAXIMUM VOLTAGE | POWER CONSUMPTION |
|----|-------------------|--------------------------------------|--------------------------------|----------------------|-----------------|-------------------|
| | | | % OF RATED VOLTAGE (At +20 °C) | | | |
| AC | 6 | 5 | 80 Max. | 10 Min. | 120MAX. | 2.5VA Approx. |
| | 12 | 20 | | | | |
| | 24 | 78 | | | | |
| | 110 | 1800 | | | | |
| | 220 | 6700 | | | | |
| DC | 6 | 24 | 80 Max. | 30 Min. | 120MAX. | 1.6W Approx. |
| | 12 | 96 | | | | |
| | 24 | 388 | | | | |
| | 48 | 1550 | | | | |

CHARACTERISTICS

| | |
|---------------------------------|--|
| Contact Arrangement | 4PDT |
| Contact Material | AGCDO |
| Contact Resistance | 50m Ω Max. |
| Contact Rating (Resistive Load) | 10A 28V DC / 220V AC |
| Switching Voltage | 125V DC/ 250V AC Max. |
| Operate Time | 25ms Max. |
| Release Time | 25ms Max. |
| Insulation Resistance | 1000M Ω Min. (500V DC) |
| Dielectric Strength | 1500V AC(50Hz/min.) Between contacts 2000V AC(50Hz/min.) Between coil and contact |
| Shock Resistance | 15g Approx. |
| Vibration Resistance | 1.5mm Double amplitude, 10-50Hz |
| Ambient Temperature | -50°C to +70°C |
| Humidity | 45 - 85% RH |
| Operation Life | Mechanical : 10^7 Electrical : 10^5 |
| Weight | 70g Approx. |

[Specifications are subject to change without notices.]

ORDERING INFORMATION

M4 - A L S DC 12V

RATED VOLTAGE

NIL : WITHOUT SOCKET

S : WITH SOCKET TYPE

NIL : WITHOUT INDICATOR LIGHT

L : WITH INDICATOR LIGHT

A : PCB MOUNTING

B : PLUG IN TYPE

RELAY MODEL

DIMENSIONS (UNIT: mm)

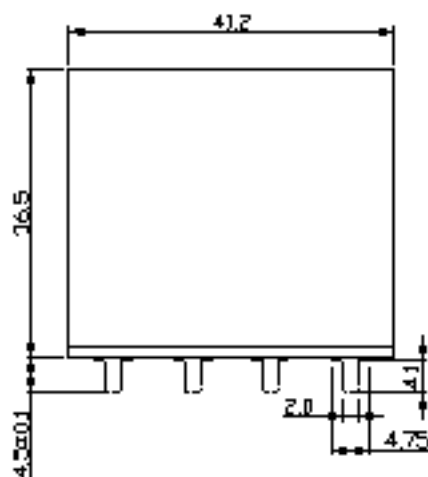

PLUG IN TYPE TERMINAL (BOTTOM VIEW)

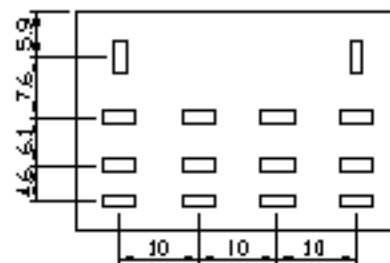

TERMINAL ARRANGEMENT (BOTTOM VIEW)

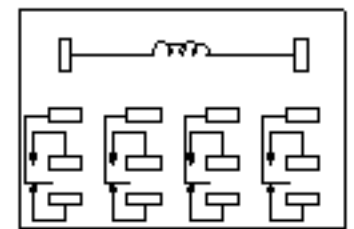

PCB TYPE TERMINAL (BOTTOM VIEW)

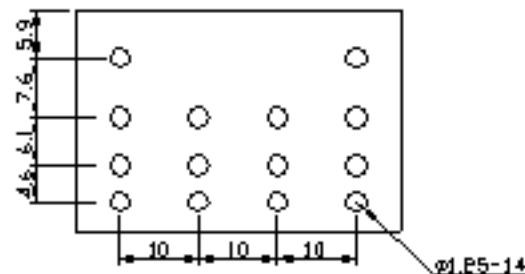

PLUG IN TYPE (SOCKET TYPE)

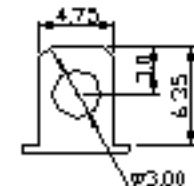

PCB TYPE

